

Eye Nut

Material: Stainless Steel

Class Grade: A4-70 G316

Corrosion Protection Level: Ultimate

Comments: This product range is not rated and has no markings. Breaking load information provided is to be used as a guide only

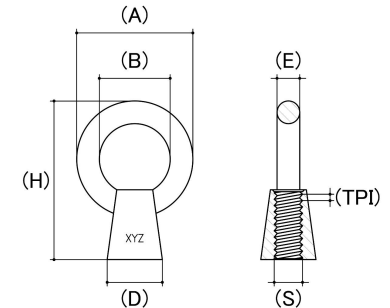

*Cad Drawings shown for graphic representation only.**

Size	Thread Pitch (mm)	Thread Type	Height Overall (H) (mm)	Collar Width (D) (mm)	Inside dia. of Eye (B) (mm)		Outside Diameter Of Eye (A) (mm)	Thickness Of Eye (E) (mm)	Breaking Load Kgs (Not Rated Guide only)	sku (Part Number)
			Nom	Nom	Min	Max	Nom	Nom	Nom	
M6	1.00mm	Coarse	31.00	13.00	16.00	17.00	26.00	5.00	1100	61ENS6M
M8	1.25mm	Coarse	38.50	16.00	20.00	21.00	32.60	6.30	1300	61ENS8M
M10	1.50mm	Coarse	49.00	20.00	25.00	26.00	41.00	8.00	2600	61ENS10M
M12	1.75mm	Coarse	60.00	25.00	30.00	31.00	50.00	10.00	3400	61ENS12M
M16	2.00mm	Coarse	70.50	30.00	34.00	35.00	60.00	12.50	8000	61ENS16M
M20	2.50mm	Coarse	85.50	35.00	39.00	40.00	72.00	16.00	10500	61ENS20M
M24	3.00mm	Coarse	90.00	45.00	49.00	50.00	90.00	20.00	12000	61ENS24M

Disclaimer:

Dimensional data and technical information was obtained from publically available sources and not acquired through standard agencies. It has been completed and compiled for reference purposes only; where discrepancies are found they are subject to change without notice. Bolt & Nut Australia makes no warranties or representations regarding the accuracy and validity of the compiled information and data. Contact the relevant standard authorities for accurate and detailed information.

* Cad Drawings may not reflect diameter, thread length or overall length.

© Bolt & Nut Australia Pty Ltd. All rights reserved.

Version: 23 Sep 2024